

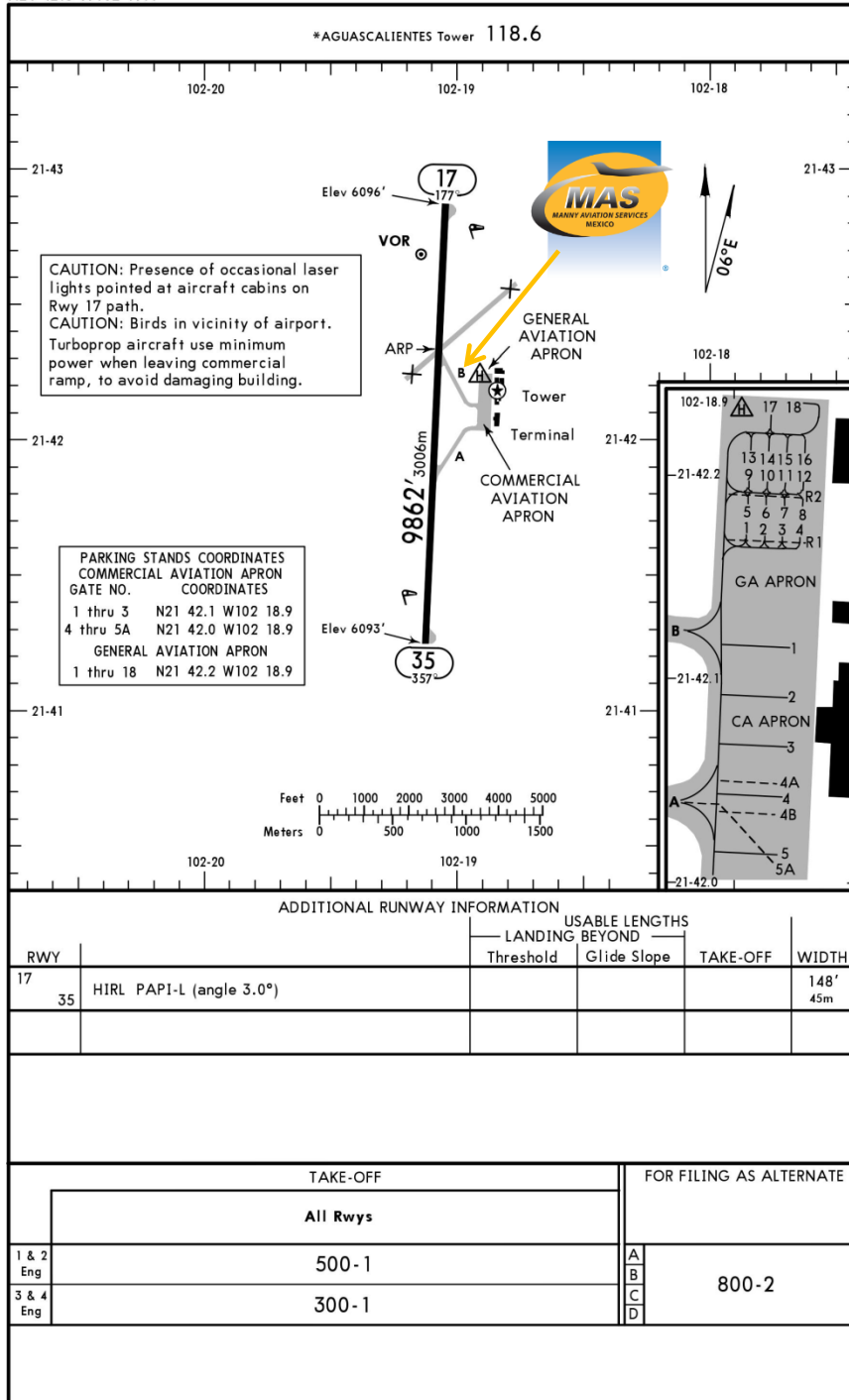

MMAS/AGU
LIC. JESUS TERAN PEREDO INTERNATIONAL AIRPORT

MMAS/AGU
Apt Elev 6112'
N21 42.3 W102 19.1

JEPPESEN AGUASCALIENTES, MEXICO
20 APR 18 (10-9) Eff 26 Apr
JESUS TERAN INTL



Address:

Km. 22 Carretera Panamericana
Ejido Buenavista de Peñuelas
Aguascalientes, Ags. ZC 20340.

Telephone: +52 (722) 273 0981.

Operational Information

Operational hours: Winter 1200-0600 UTC / Summer 1100-0500 UTC.

Customs and immigration: During airport operational hours.

Fuel available : Avgas 100/130, Jet A.

Fuel delays can be expected as the government fuel provider has top priority for commercial operations.

Fuel method of payment:

Credit card, debit card, Uvair-World Fuel card or ASA release.

Catering: Catering orders are

available upon request (24 hours in advance).

Manny's Representative: Julio César Flores Elorriaga

Fire Cat: VI.



MMAS/AGU LIC. JESUS TERAN PEREDO INTERNATIONAL AIRPORT

Arrival

1. Upon arrival, crew must follow ATC instructions for taxiing to General Aviation Apron through taxiways A or B depending on the arriving runway.
2. Crew and passenger passports will be asked by staff representative to take them to immigration and customs facilities.
3. When all passengers deplane, customs, National Guard and agriculture officers will come onboard to make a quick inspection. Please remember that all luggage must be offloaded and food will be disposed.
4. Passengers must walk inside the general aviation building to make the CIQ (Customs, Immigration and quarantine) processes. Luggage cannot be inspected without passenger's presence.
5. Passengers can exit from General Aviation or from the FBO.
6. The whole process will take around 20-25 minutes.
7. The aircraft will be towed to the FBO Mira.

Departure

1. Crew and passenger passports will be asked by our staff representative to take them to immigration facilities as well as their luggage.
2. The luggage will be taken inside the x ray clearance due a brief security inspection.
3. The whole process will take around 20-25 minutes.

This process could present delays due that Customs & Immigration authorities have top priority for commercial operations.

